

Six Forks

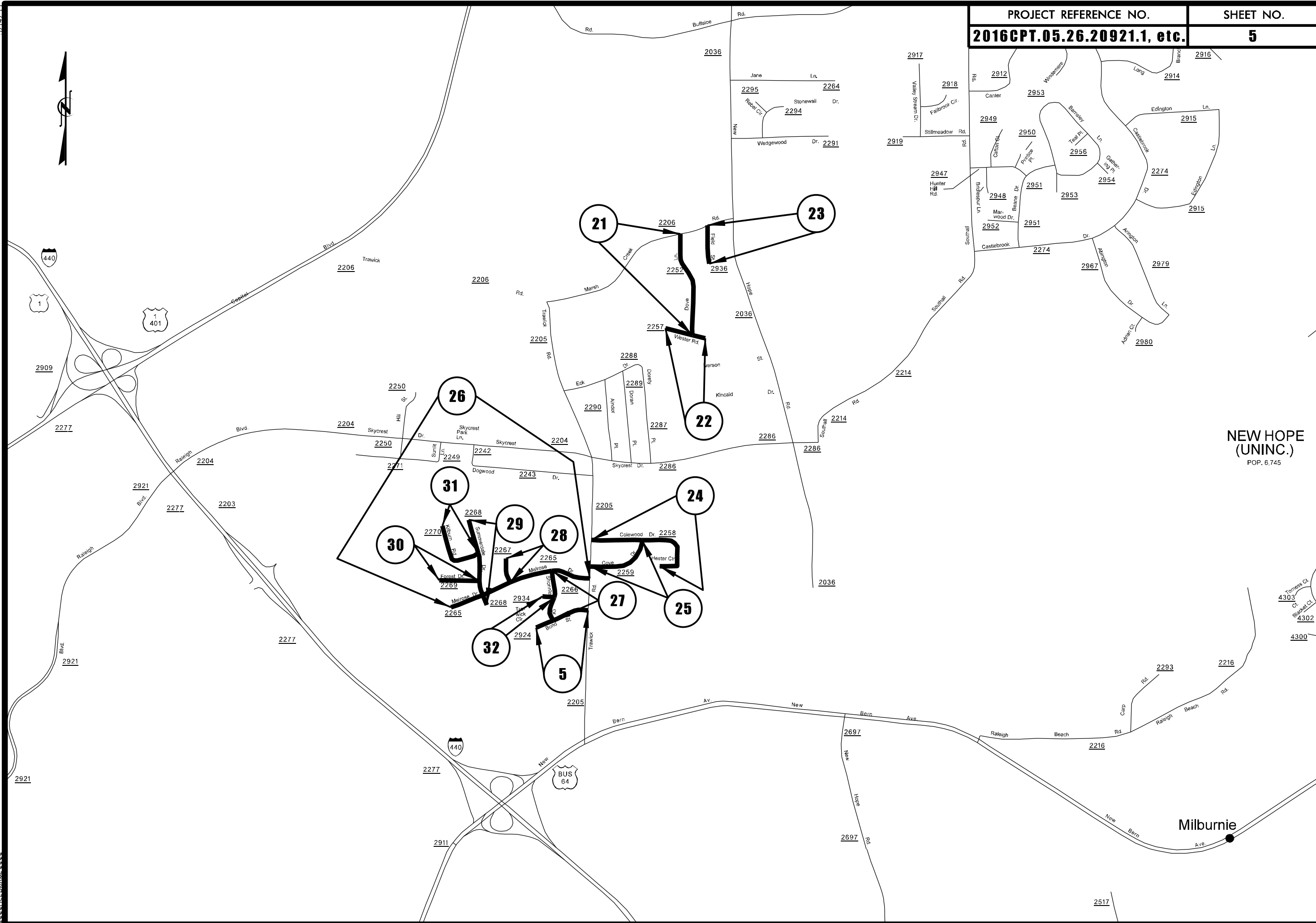

5/14/99

5/14/19



NEW HOPE (UNINC.) POP. 6,745

Milburnie

C:\PROJECTS\2016CPT\2016CPT.05.26.20921.1\2016CPT.05.26.20921.1.dwg

PAVEMENT SCHEDULE

C1	1½" ASPHALT CONCRETE SURFACE COURSE, TYPE SF9.5A, AT AN AVERAGE RATE OF 165 LBS. PER SQ. YD.
C2	1" ASPHALT CONCRETE SURFACE COURSE, TYPE S4.75A, AT AN AVERAGE RATE OF 100 LBS. PER SQ. YD.
U	EXISTING PAVEMENT

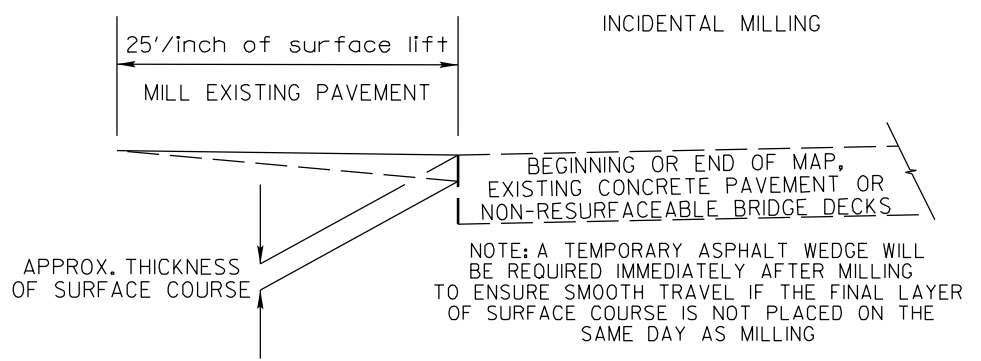

NOTES

ALL UNPAVED S.R. ROADS TO BE RESURFACED 50' FROM EDGE OF PAVEMENT OF MAIN PROJECT
 ALL PAVED S.R. ROADS TO BE RESURFACED TO THE ENDS OF THE RADII, OR AS DIRECTED BY THE ENGINEER.
 EDGES, PAVEMENT WIDENING, INTERSECTIONS AND BRIDGE FLARES ARE INCLUDED IN THE TABLE OF QUANTITIES.
 BRIDGES TO BE RESURFACED AT LOCATIONS AND TO DEPTH AS DIRECTED BY THE ENGINEER.

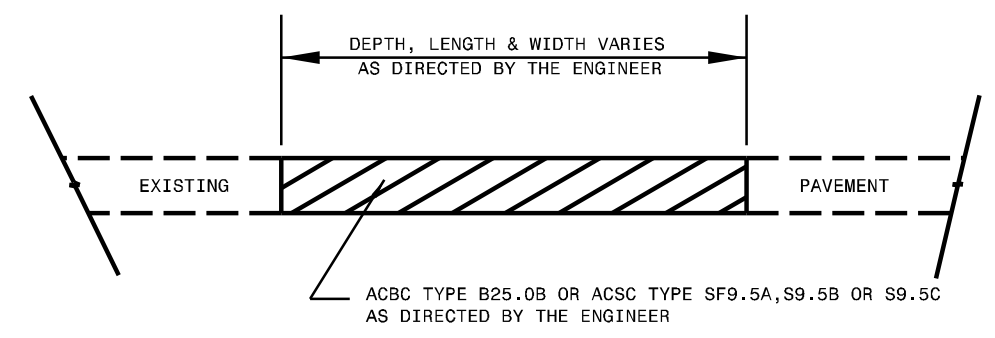

PATCHING EXISTING PAVEMENT
 PATCHING TO BE PERFORMED PRIOR TO MILL AND FILL OPERATION

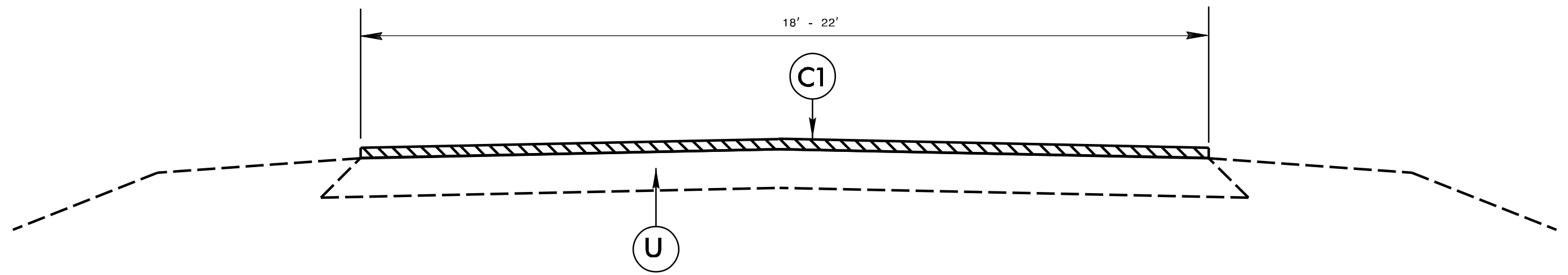

TYPICAL SECTION NO. 1

PAVEMENT SCHEDULE

C1	1½" ASPHALT CONCRETE SURFACE COURSE, TYPE SF9.5A, AT AN AVERAGE RATE OF 165 LBS. PER SQ. YD.
C2	1" ASPHALT CONCRETE SURFACE COURSE, TYPE S4.75A, AT AN AVERAGE RATE OF 100 LBS. PER SQ. YD.
U	EXISTING PAVEMENT

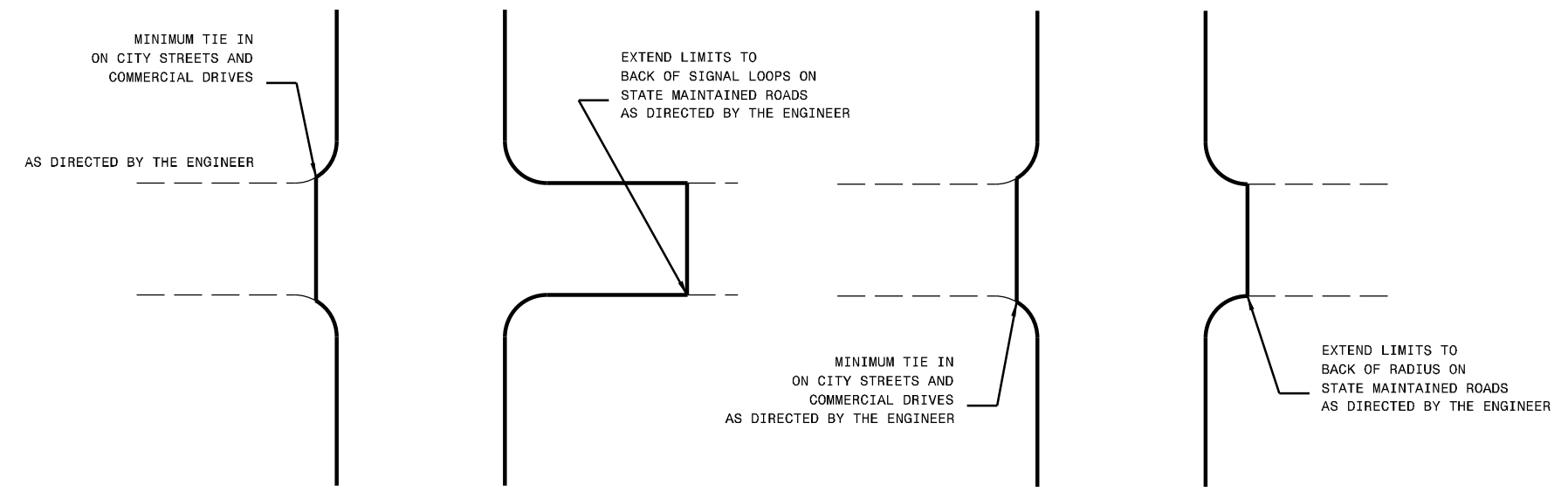

DETAIL OF PROJECT LIMITS AT SIGNALIZED Y LINES

DETAIL OF PROJECT LIMITS AT UNSIGNALIZED Y LINES

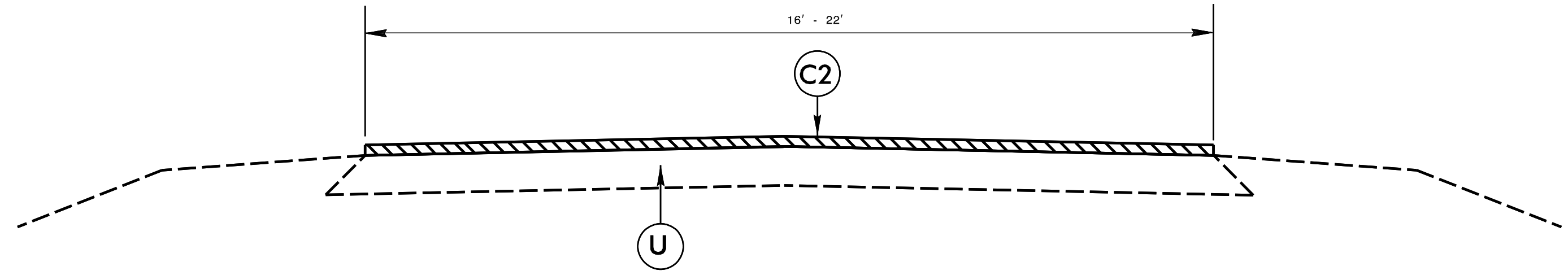

TYPICAL SECTION NO. 2

PROJECT NO.	SHEET NO.	TOTAL NO.
2016CPT.05.26.20921.1		
2016CPT.05.26.20922.1		

SUMMARY OF QUANTITIES

PROJECT NO	COUNTY	MAP NO	ROUTE	DESCRIPTION	TYP	LANES	LANE TYPE	FINAL SURFACE TESTING REQUIRED	WARM MIX ASPHALT REQUIRED	LENGTH		INCIDENTAL STONE BASE	INCIDENTAL MILLING	SURFACE COURSE, SF9.5A		SURFACE COURSE, S4.75A	ASPHALT BINDER FOR PLANT MIX	PATCHING EXISTING PAVEMENT	ADJUST MANHOLES	ADJUST METER OR VALVE BOX
										MI	FT			TONS	SY					
2016CPT.05.26.20921.1	Wake	1	SR 2132 - DEAN AVE	SR 2133 TO SR 2041	1	2		NO	NO	0.468	20	23	127	455			30	72		
TOTAL FOR MAP NO. 1										0.468		23	127	455			30	72		
2016CPT.05.26.20921.1	Wake	2	SR 2133 - WILL O DEAN RD	SR 2132 TO SR 2197	1	2		NO	NO	0.5	20	25	105	486			33	42		
TOTAL FOR MAP NO. 2										0.5		25	105	486			33	42		
2016CPT.05.26.20921.1	Wake	3	SR 2134 - SPRING VALLEY DR	SR 2133 TO CUL-DE-SAC	1	2		NO	NO	0.5	20	25		526			35	92		
TOTAL FOR MAP NO. 3										0.5		25		526			35	92		
2016CPT.05.26.20921.1	Wake	4	SR 2135 - OLD ELIZABETH RD	SR 2132 TO SR 2197	1	2		NO	NO	0.392	20	20	127	381			26	24		
TOTAL FOR MAP NO. 4										0.392		20	127	381			26	24		
2016CPT.05.26.20921.1	Wake	5	SR 2924 - BOND ST	SR 2205 TO EOM	1	2		NO	NO	0.182	22	9	205	273			18	120		
TOTAL FOR MAP NO. 5										0.182		9	205	273			18	120		
2016CPT.05.26.20921.1	Wake	6	SR 2958 - LANDOVER DR	SR 2049 TO RALEIGH CITY LIMITS	1	2		NO	NO	0.423	19	21	156	411			28	12		
TOTAL FOR MAP NO. 6										0.423		21	156	411			28	12		
2016CPT.05.26.20921.1	Wake	7	SR 3289 - SOUTHAMPTON DR	NC 50 TO CUL-DE-SAC	1	2		NO	NO	0.472	22	24	179	483			32	120		
TOTAL FOR MAP NO. 7										0.472		24	179	483			32	120		
2016CPT.05.26.20921.1	Wake	8	SR 3532 - JACQUELINE LN	SR 3514 TO CUL-DE-SAC	1	2		NO	NO	0.07	20	4	185	97			7	12		
TOTAL FOR MAP NO. 8										0.07		4	185	97			7	12		
2016CPT.05.26.20921.1	Wake	9	SR 3514 - BERKSHIRE DOWNS DR	SR 2006 TO SR 3514	1	2		NO	NO	1.14	20	57	149	1,166			78	144		
TOTAL FOR MAP NO. 9										1.14		57	149	1,166			78	144		
2016CPT.05.26.20921.1	Wake	10	SR 3550 - TAYLORS RIDGE RD	SR 2044 TO CUL-DE-SAC	1	2		NO	NO	0.506	21	25	86	542			36	72		
TOTAL FOR MAP NO. 10										0.506		25	86	542			36	72		
2016CPT.05.26.20921.1	Wake	11	SR 3564 - GREENVILLE LOOP RD	SR 2044 TO EOM	1	2		NO	NO	0.77	21	39	259	748			50	120		
TOTAL FOR MAP NO. 11										0.77		39	259	748			50	120		
2016CPT.05.26.20921.1	Wake	12	SR 4431 - ROXBURY DR	SR 2044 TO CUL-DE-SAC	1	2		NO	NO	0.51	21	26	127	504			34	24		
TOTAL FOR MAP NO. 12										0.51		26	127	504			34	24		
2016CPT.05.26.20921.1	Wake	13	SR 4434 - THORNDIKE DR	SR 4431 TO EOM	1	2		NO	NO	0.091	21	5	86	84			6	7		
TOTAL FOR MAP NO. 13										0.091		5	86	84			6	7		
2016CPT.05.26.20921.1	Wake	14	SR 3568 - OCTOBER RD	SR 2000 TO EOM	1	2		NO	NO	0.42	21	21	154	451			30	43		
TOTAL FOR MAP NO. 14										0.42		21	154	451			30	43		
2016CPT.05.26.20921.1	Wake	15	SR 3577 - COOL SPRING RD	SR 3576 TO EOM	1	2		NO	NO	0.23	18	12	74	235			16	17		
TOTAL FOR MAP NO. 15										0.23		12	74	235			16	17		
2016CPT.05.26.20921.1	Wake	16	SR 4496 - COOLMORE DR	SR 2000 TO SR 3568	1	2		NO	NO	0.26	20	13	126	266			18	24		
TOTAL FOR MAP NO. 16										0.26		13	126	266			18	24		
TOTAL FOR PROJ NO. 2016CPT.05.26.20921.1										6.934		349	2,145	7,108			477	945		

PROJECT NO.	SHEET NO.	TOTAL NO.
2016CPT.05.26.20921.1,		
2016CPT.05.26.20922.1		

THERMOPLASTIC AND PAINT QUANTITIES

PROJECT NO	COUNTY	MAP NO	ROUTE	DESCRIPTION	TYP	LANES	LANE TYPE	LENGTH	WIDTH	4413000000-E	4457000000-N	
										WORK ZONE ADVANCE/GENERAL WARNING SIGNING SF	TEMPORARY TRAFFIC CONTROL LS	
2016CPT.05.26.20921.1	Wake	1	SR 2132 - DEAN AVE	SR 2133 TO SR 2041		2		0.468	20	53	0.03	
TOTAL FOR MAP NO. 1											53	0.03
2016CPT.05.26.20921.1	Wake	2	SR 2133 - WILL O DEAN RD	SR 2132 TO SR 2197		2		0.5	20	56	0.03	
TOTAL FOR MAP NO. 2											56	0.03
2016CPT.05.26.20921.1	Wake	3	SR 2134 - SPRING VALLEY DR	SR 2133 TO CUL-DE-SAC		2		0.5	20	21	0.04	
TOTAL FOR MAP NO. 3											21	0.04
2016CPT.05.26.20921.1	Wake	4	SR 2135 - OLD ELIZABETH RD	SR 2132 TO SR 2197		2		0.392	20	44	0.03	
TOTAL FOR MAP NO. 4											44	0.03
2016CPT.05.26.20921.1	Wake	5	SR 2924 - BOND ST	SR 2205 TO EOM		2		0.182	22	21	0.02	
TOTAL FOR MAP NO. 5											21	0.02
2016CPT.05.26.20921.1	Wake	6	SR 2958 - LANDOVER DR	SR 2049 TO RALEIGH CITY LIMITS		2		0.423	19	48	0.03	
TOTAL FOR MAP NO. 6											48	0.03
2016CPT.05.26.20921.1	Wake	7	SR 3289 - SOUTHAMPTON DR	NC 50 TO CUL-DE-SAC		2		0.472	22	53	0.03	
TOTAL FOR MAP NO. 7											53	0.03
2016CPT.05.26.20921.1	Wake	8	SR 3532 - JACQUELINE LN	SR 3514 TO CUL-DE-SAC		2		0.07	20	16	0.01	
TOTAL FOR MAP NO. 8											16	0.01
2016CPT.05.26.20921.1	Wake	9	SR 3514 - BERKSHIRE DOWNS DR	SR 2006 TO SR 3514		2		1.14	20	128	0.10	
TOTAL FOR MAP NO. 9											128	0.10
2016CPT.05.26.20921.1	Wake	10	SR 3550 - TAYLORS RIDGE RD	SR 2044 TO CUL-DE-SAC		2		0.506	21	58	0.04	
TOTAL FOR MAP NO. 10											58	0.04
2016CPT.05.26.20921.1	Wake	11	SR 3564 - GREENVILLE LOOP RD	SR 2044 TO EOM		2		0.77	21	87	0.05	
TOTAL FOR MAP NO. 11											87	0.05
2016CPT.05.26.20921.1	Wake	12	SR 4431 - ROXBURY DR	SR 2044 TO CUL-DE-SAC		2		0.51	21	58	0.03	
TOTAL FOR MAP NO. 12											58	0.03
2016CPT.05.26.20921.1	Wake	13	SR 4434 - THORNDIKE DR	SR 4431 TO EOM		2		0.091	21	16	0.01	
TOTAL FOR MAP NO. 13											16	0.01
2016CPT.05.26.20921.1	Wake	14	SR 3568 - OCTOBER RD	SR 2000 TO EOM		2		0.42	21	48	0.04	
TOTAL FOR MAP NO. 14											48	0.04
2016CPT.05.26.20921.1	Wake	15	SR 3577 - COOL SPRING RD	SR 3576 TO EOM		2		0.23	18	26	0.02	
TOTAL FOR MAP NO. 15											26	0.02
2016CPT.05.26.20921.1	Wake	16	SR 4496 - COOLMORE DR	SR 2000 TO SR 3568		2		0.26	20	30	0.02	
TOTAL FOR MAP NO. 16											30	0.02
TOTAL FOR PROJ NO. 2016CPT.05.26.20921.1								6.934		763	0.53	

SIGNING FOR RESURFACING PROJECTS

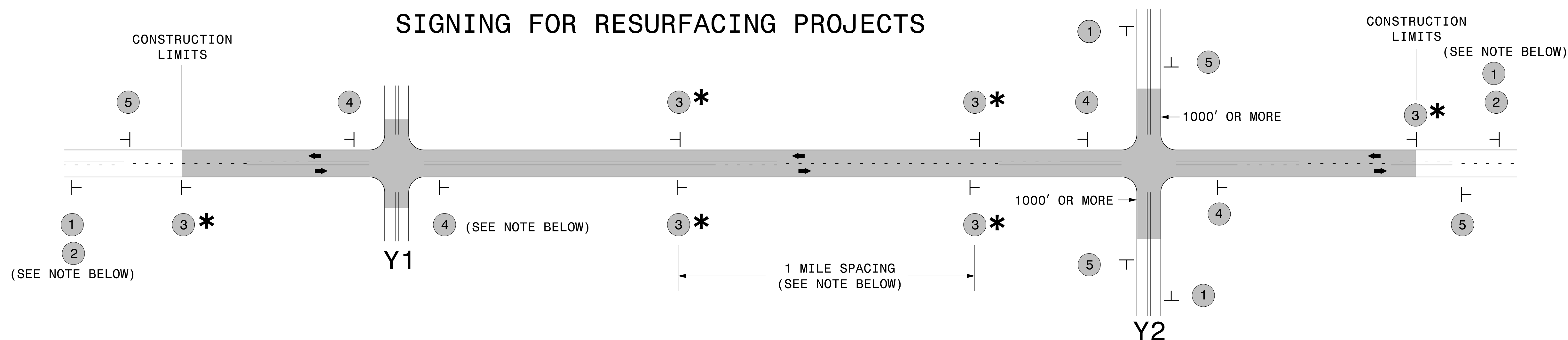

LEGEND	
	STATIONARY SIGN
←	DIRECTION OF TRAFFIC FLOW

MAINLINE (-L-) SIGNING

-Y- LINE SIGNING

SIGNING NOTES AND PLACEMENT PER DIRECTION		
1 2		<p style="text-align: center;">NO REQUIRED STATIONARY SIGNING FOR THE FOLLOWING -Y- LINE CONDITIONS:</p> <ol style="list-style-type: none"> 1) LESS THAN 1000' OF RESURFACING ALONG -Y- LINE 2) SUBDIVISION ROADS 3) DEAD END ROADS <p style="text-align: center;">WHEN PAVING/CONSTRUCTION ACTIVITIES PROCEED ACROSS AN UNSIGNED -Y- LINE, ADVANCE WARNING PORTABLE SIGNS SHALL BE USED ALONG THE -Y- LINE AS SHOWN BELOW. REMOVE UPON COMPLETION OF WORK.</p> <div style="display: flex; justify-content: space-around; align-items: center;"> <div style="text-align: center;"> <p style="font-size: small;">W20-1 48" X 48"</p> </div> <div style="text-align: center;"> <p style="font-size: small;">W20-7 A 48" X 48"</p> </div> </div> <p style="text-align: center;">PLACED 500' IN ADVANCE OF FLAGGER. PLACED 250' IN ADVANCE OF FLAGGER.</p>
3 *		
4		
5		

* SIGNING FOR ASPHALT SURFACE TREATMENTS (ONLY)

SUBSTITUTE LOW/SOFT SHOULDER SIGNS BY ALTERNATING THE FOLLOWING TWO SIGNS:
STARTING WITH "UNMARKED PAVEMENT AHEAD" (SP 06026) FOLLOWED BY "LOOSE GRAVEL" (W8-7).



**RESURFACING
ADVANCE WARNING SIGNS
FOR
RURAL AND SUBURBAN
2 LANE ROADWAYS**